

TAT ONE-PIECE

millimetres
inches

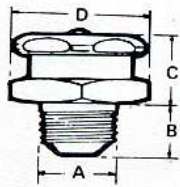

Thread A	Dim. B	Dim. C	Dim. D	Part No.
3/8" B.S.F.	6.4 .25	8.9 .35	15.2 .600	NB 5956/101
1/8" B.S.P.F.	6.4 .25	8.9 .35	15.2 .600	NB 5959 ††
1/8" B.S.P.F.	6.4 .25	8.9 .35	15.2 .600	NB 5962/103
1/4" B.S.P.F.	8.4 .33	8.9 .35	15.2 .600	NB 5975 ††
1/4" B.S.P.F.	8.4 .33	8.9 .35	15.2 .600	NB 5976/101
1/8" - 27 NPT	8.0 .32	8.4 .33	15.2 .600	NB 5967/101

METRIC TAT

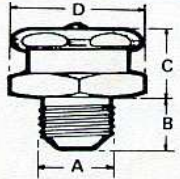

M6 x 1.00	6.0 .24	10.0 .39	15.0 .59	NB7401
M8 x 1.00	6.0 .24	10.0 .39	15.0 .59	NB7402
M8 x 1.25	6.0 .24	10.0 .39	15.0 .59	NB7403
M10 x 1.00	6.0 .24	10.0 .39	15.0 .59	NB7404
M10 x 1.50	6.0 .24	10.0 .39	15.0 .59	NB7405
M12 x 1.75	6.0 .24	10.0 .39	15.0 .59	NB7406

MINIATURE TAT

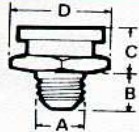

1/4" B.S.F.	5.0 .20	6.0 .24	11.3 .445	NB 5951
-------------	---------	---------	-----------	---------

TAT CAP

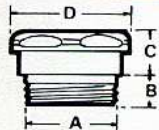

M12 x .75	3.6 .14	6.2 .24	15.2 .600	NB 5971§
M12 x .75	3.6 .14	6.2 .24	15.2 .600	NB 5972/103

INDUSTRIAL BUTTON HEAD

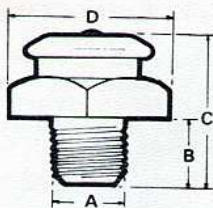

Thread A	Dim. B	Dim. C	Dim. D	Part No.
1/8" B.S.P.F.	9.0 .35	19.7 .78	18.0 .710	ND 6172
1/4" B.S.P.F.	12.4 .49	24.3 .96	18.0 .710	ND 6160
3/8" B.S.P.F.	12.4 .49	24.3 .96	18.0 .710	ND 6161

GIANT BUTTON HEAD

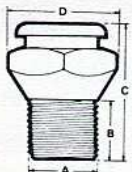

1/4" B.S.P.F.	13.8 .55	33.0 1.30	22.0 .875	ND 6150
3/8" B.S.P.F.	13.8 .55	33.0 1.30	22.0 .875	ND 6151